

UniLifter®

Undercut Release System

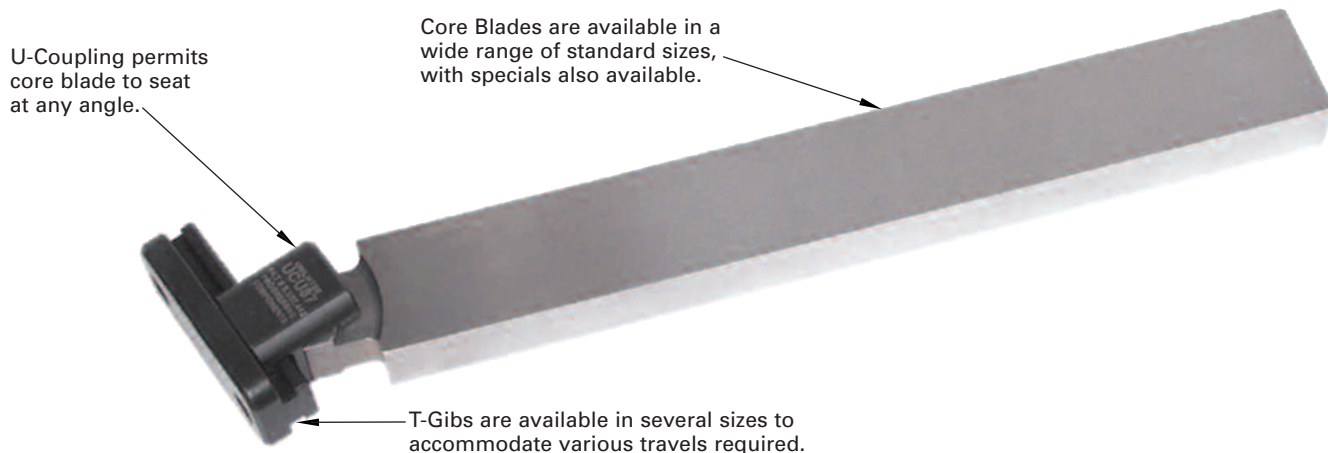

The UniLifter undercut release system incorporates a three piece set: Core Blade, U-Coupling, and T-Gib.

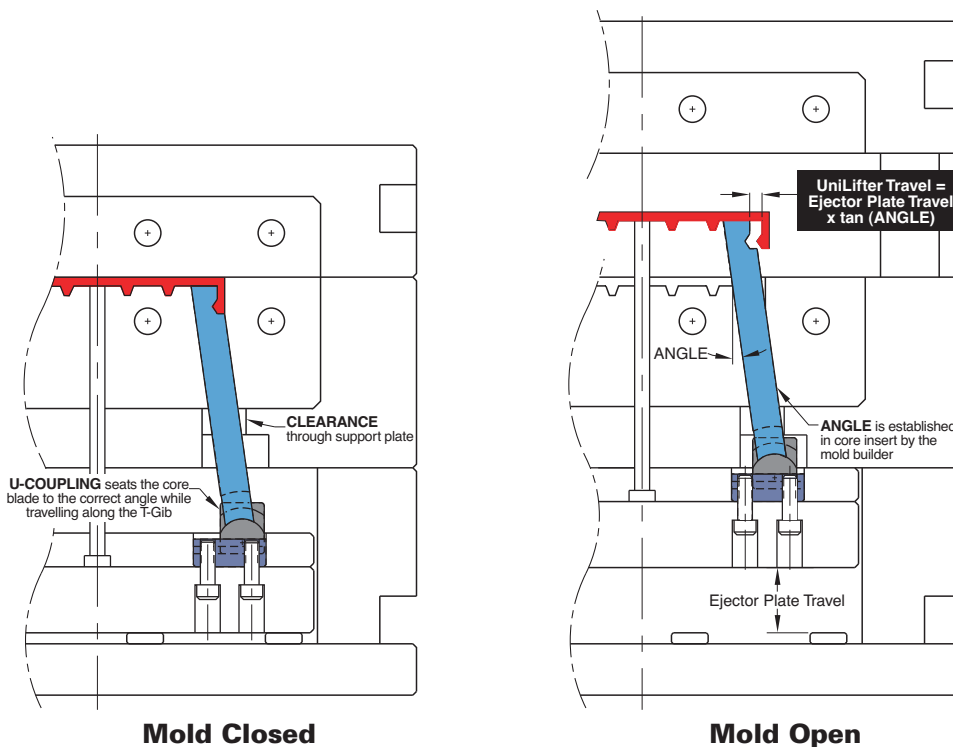

Application Guidelines:

1. Typical angle is 5-10°, though users report success at greater angles with guides installed. Contact Engineering for application review.
2. Guided Ejection is recommended, and if there is less than half of the Core Blade bearing in the insert, lifter guide plates should be added.
3. Recommended clearance is .001"-.0015" (.025-.038mm) where permissible.
4. Verify that the core insert material is at least 10 HRC different than standard standard Core Blades, and for additional performance, consider coatings or treatments for increased hardness or lubricity.
5. Locking angles can be designed to accept molding pressure, and non-standard sizes or pre-roughed Core Blades can be provided by accessing www.procomps.com/customs.

US Patent No. 5,137,442, and No. 5,316,467
 Canadian Patent No. 2,048,218
 European Patent No. EP498102
 Mexican Patent No. 175084